

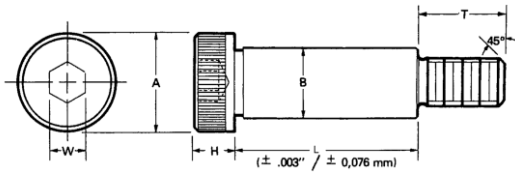

P C R – PARAFUSO CORPO RETIFICADO



Material: Aço Liga

Trat. Térmico: Temperado - Dureza 39 a 44 HRC

Perpendicularidade entre a área de apoio da cabeça e o eixo do corpo retificado dentro do desvio máximo de dois graus.

Acabamento: Oxidado

Referência: ISO 7379 (DIN 9841) e ANSI B 18.3

TABELA EM MILÍMETROS

B	6	8	10	12	16	20
Rosca	M5-0.8	M6-1.0	M8-1.25	M10-1.5	M12-1.75	M16-2.0
A	10	13	16	18	24	30
H	4.5	5.5	7.0	8.0	10.0	14.0
T	9.75	11.25	13.25	16.25	18.25	22.25
W	3	4	5	6	8	10
L						
10	B6010					
12	B6012	B8012				
16	B6016	B8016	B10016			
20	B6020	B8020	B10020	B12020		
25	B6025	B8025	B10025	B12025	B16025	
30	B6030	B8030	B10030	B12030	B16030	B20030
40	B6040	B8040	B10040	B12040	B16040	B20040
50	B6050	B8050	B10050	B12050	B16050	B20050
60	B6060	B8060	B10060	B12060	B16060	B20060
70	B6070	B8070	B10070	B12070	B16070	B20070
80		B8080	B10080	B12080	B16080	B20080
90			B10090	B12090	B16090	B20090
100				B12100	B16100	B20100
120					B16120	B20120

TABELA EM POLEGADAS

B	1/4	5/16	3/8	1/2	5/8	3/4
Rosca UNC	#10	1/4	5/16	3/8	1/2	5/8
A	.375	.438	.562	.750	.875	1.000
H	.188	.219	.250	.313	.375	.500
W	.125	.156	.187	.250	.312	.375
T	.375	.437	.500	.625	.750	.875
L						
3/8	B6510					
1/2	B6512	B7512				
5/8	B6516	B7516	B9516			
3/4	B6520	B7520	B9520	B12520		
1	B6525	B7525	B9525	B12525	B15525	B19525
1 1/4	B6530	B7530	B9530	B12530	B15530	B19530
1 1/2	B6540	B7540	B9540	B12540	B15540	B19540
2	B6550	B7550	B9550	B12550	B15550	B19550
2 1/4	B6560	B7560	B9560	B12560	B15560	B19560
2 1/2	B6570	B7570	B9570	B12570	B15570	B19570
3		B7580	B9580	B12580	B15580	B19580
3 1/2			B9590	B12590	B15590	B19590
4				B12500	B15500	B19500

Consulte para outras medidas ou características especiais.

FIXADORES



MOLAS

Pois comerás do trabalho das tuas mãos, feliz serás, e te irá bem. Sl 128:2